

SA-ACxxHQ3-000

Static accelerometer (3 axis) high quality

Function

- Sensor / amplifier combination to measure axial accelerations in three axis

Features

- No temperature drift influence
- No vibration influence to the signal
- High resistance to vibration shock

Options

- With the amplifier, the measuring range can be adjusted to your specifications
- Measuring ranges between $\pm 1G$ to $\pm 50G$ are possible
- Sensor / amplifier combination will be delivered with calibration sheet



Technical specifications

Electrical characteristics

Voltage supply.....	12 V DC
Output voltage.....	0-5 V
Measuring range..... (other ranges on request)	$\pm 1 / 3 / 10 / 50$ G
Frequency response.....	25 Hz
Error for linearity.....	<1% of FS
Shock resistance..... (in measuring direction)	10000 G

Calibration

Use the formulas on 2nd page to calculate the physical Values.

Mechanical characteristics

Dimensions.....	38 x 38 x 38 mm
Weight.....	155 g
Housing material.....	aluminium
Cable	
type.....	Raychem
wire cross section..	5 x AWG 26
Connector.....	open wires

Environmental data

Ambient operating range.....	-25 to +100 °C
Humidity.....	5 to 95 %
Sealing class.....	IP 67

Ordering information

Art.No.:..... SA-ACxxHQ3-000
 see order code on second page for more details

SA-ACxxHQ3-000

Static accelerometer (3 axis) high quality

Dimensions

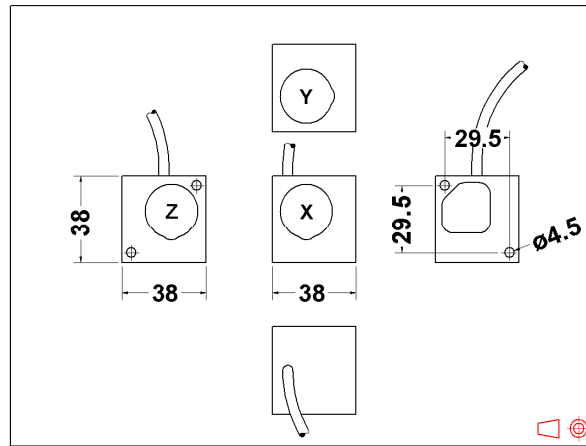

Formulas

	SA-ACxxHQ3-000	Multiplier				Offset		
12 Bit A/D	Acceleration [G]	=	2 * xx / 4095				*	Digits - xx
16 Bit A/D	Acceleration [G]	=	2 * xx / 65535				*	Digits - xx
Voltage*)	Acceleration [G]	=	0.4	1.2	4	20	*	Volt - xx

SA-AC01HQ3	SA-AC03HQ3	SA-AC10HQ3	SA-AC50HQ3
------------	------------	------------	------------

Replace the **xx** with the acceleration of your sensor:
 → Possible values are 1, 3, 10 or 50G (other values on request)

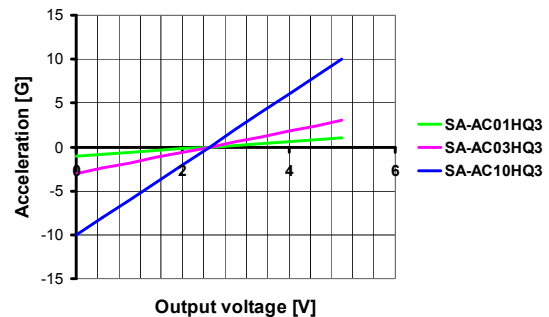

Connector layout

	Pin	Name	Description	Color
Analog-line Open wires		AGND	Analog Ground	black
		+12V	Power supply	red
		Signal x	x-axis signal	white
		Signal y	y-axis signal	yellow
		Signal z	z-axis signal	brown

Connector type

Sensor with open wires (standard)



Possible options (reference cable and connector) on customer request !

Ordering information

Measuring ranges	order code
Three axis..... ±1G	/ SA-AC01HQ3-000
Three axis..... ±3G	/ SA-AC03HQ3-000
Three axis..... ±5G	/ SA-AC05HQ3-000
Three axis..... ±10G	/ SA-AC10HQ3-000
Three axis..... ±50G	/ SA-AC50HQ3-000

The specifications on this document are subject to change at 2D decision. 2D assumes no responsibility for any claims or damages arising out of the use of this document, or from the use of modules based on this document, including but not limited to claims or damages based on infringement of patents, copyrights or other intellectual property rights.

2D Debus & Diebold Meßsysteme GmbH
<http://www.2D-datarecording.com>
<http://www.2D-Kit-System.com>
mail@2D-datarecording.com